

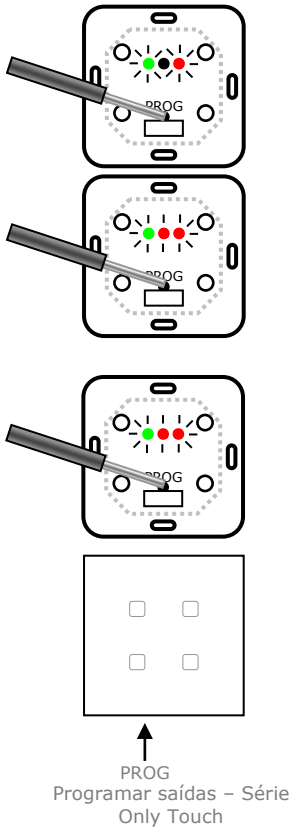

Programming Instructions



ONLY Automation - Quick Instructions Guide



Button function configuration

- 1.) Press and hold PROG for 2 seconds.
- 2.) Press the button you want to change the function:
the PROG LED blinks and you hear beep sounds according to the selection.
 - 1 = Toggle
 - 2 = On/Up
 - 3 = Off/Down
 - 4 = Timer ON
 - 5 = Delay ON
 - 6 = Scenario
- 3.) Press PROG briefly as many times as necessary to select the desired function.
- 4.) Confirm by pressing button in 2.)

Assigning outputs to a button

- 1.) Press PROG briefly and select the desired output(s).
- 2.) Press the desired button.

Deleting a button from an assigned output

- 1.) Press PROG briefly and select the desired output(s).
- 2.) Press and hold PROG for 2 seconds, until the PROG LED starts blinking and you hear a beep.
- 3.) Press the button you want to delete: you will hear a long beep and the button will be removed.

Deleting all buttons assigned to an output

- 1.) Press PROG briefly and select the desired outputs(s).
- 2.) Press and hold PROG for 5 seconds until all LED's light up or until you hear a long beep.

Removing a button from all outputs

- 1.) Press PROG for 2 seconds.
- 2.) Press the desired button.
- 3.) Press and hold PROG for 5 seconds.

Reset a module to factory default

- 1.) Press and hold PROG for more than 10 seconds.

